

FR1500

Flush-Mounted RS-485 Fingerprint Reader



Features

- Single gang Standard junction box installation.
- Flush-Mounted Design for neat installation.
- RS-485 Communication Interface.
- SilkID Fingerprint Sensor and Support Live Finger Detecting.
- Stainless Steel Front casing.
- Optional Fingerprint Protective Cover.

Specifications

Additional Info

Working Temperature: -10 °C ~ 45 °C
Working Humidity: 20 ~ 95%
Dimensions(LxWxH): 121.3 × 77.3 × 38 mm
Algorithm: ZKFinger v10.0

Power Supply

Operating Voltage 12V DC
Stand-by Mode Power Consumption: 12V*60mA=0.72W
Peak Current of Fingerprint scanning: 140mA

Hardware

1.0 GHz CPU
ZKSilkID Sensor
Buzzer Prompt
Three-color Indicator Light

Standard Features

125KHz RFID Card

Communication

RS485

Compatibility

inBio/inBioPro Controllers
Standalone Fingerprint Devices

Optional Features

125KHz HID Prox Card
13.56MHz MifareCard(S50 / S70)
13.56MHz HID Iclass Card

Configuration

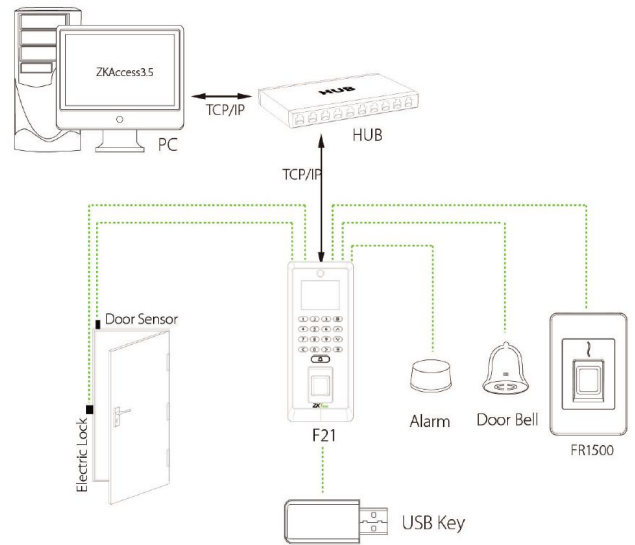
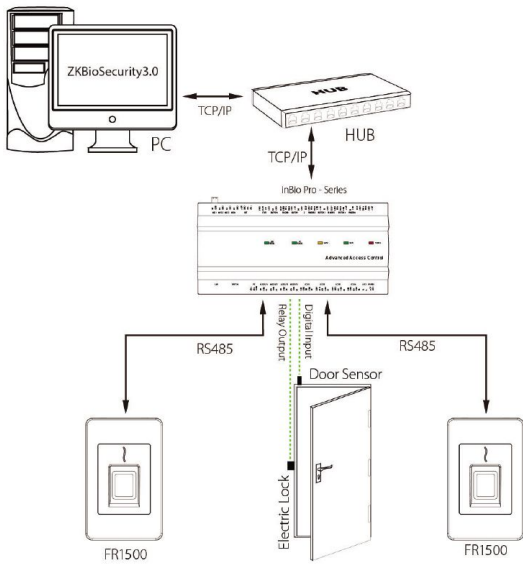

Dimensions (mm)

